

# Foundation Connectors



## Form Tie and Form Wedge

FT8, FW (U.S. Patent No. 9,834,945)

### PRODUCT FEATURES:

Traditional form boards on stem walls with lintel blocks fail to allow for proper anchor edge distances, as edge distances are reduced by 1" (i.e., the outer portion of the CMU block).

Using our Form Tie (FT8) and Form Wedge (FW) allow for increased slab coverage over stem walls, providing extra edge distance and reducing the risk of concrete failure in anchorage areas.

The Form Tie can also be used monolithic slabs. They are easily attached to the form prior to the concrete pour, and the wedges are reusable.

### MATERIAL:

FT8 – 16 gauge

FW – 12 gauge

### COATING:

Galvanized (Zinc), G90

### INSTALLATION:

Go to Videos Installations Webpage:

<http://quicktieproducts.com/video-installations/>

SKU	CARTON QTY.
FT8	72
FTW	100

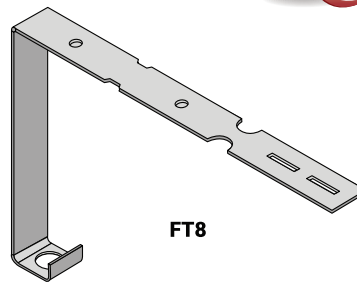

FT8

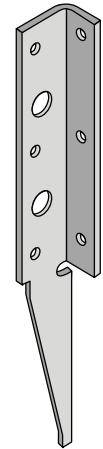

FW

